

# Voltas Customer Care Life Cycle Support

Through **MANAGED Services**

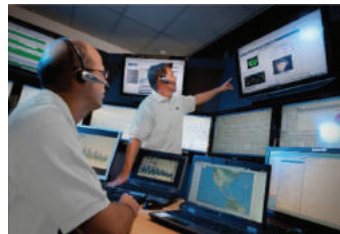

Remote Monitoring



Digital Service Reports



24x7 Helpdesk

**Voltas is 'Grade 1'  
Energy Service Company (ESCO)**

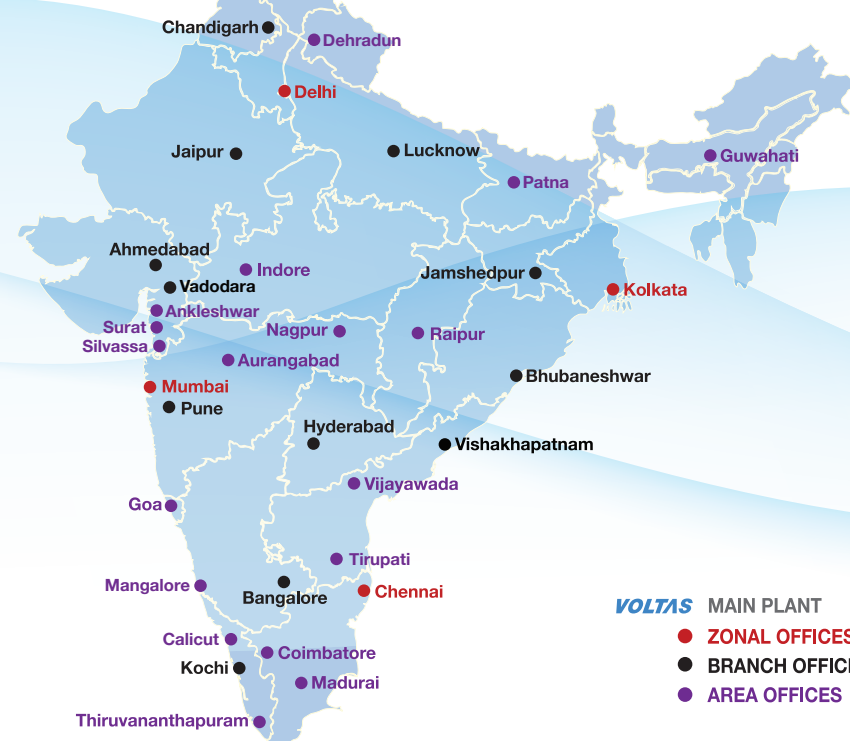

**Voltas National Network**  
Easy Access • Quick Satisfaction

**Customer Care**  
**9100660100**

**MEP Services :**

- Electro-mechanical Services
- HVAC
- Refrigeration

**Water and  
Wastewater  
Management**

**Value Added  
Services**

**VOLTAS** MAIN PLANT  
● ZONAL OFFICES  
● BRANCH OFFICES  
● AREA OFFICES

Follow us at : [f My Voltas](#) [t My Voltas](#) [i My Voltas](#) [in Voltas Limited](#) [v My Voltas](#)

**VOLTAS**

**VOLTAS LIMITED**

Domestic Projects Group, Voltas House 'B', 3rd floor, T. B. Kadam Marg, Chinchpokli, Mumbai-400 033, India  
Tel: +91 22 6665 6857. Email: [bijogeorge@voltas.com](mailto:bijogeorge@voltas.com), [jatinpanchal@voltas.com](mailto:jatinpanchal@voltas.com), [shubhambahadkar@voltas.com](mailto:shubhambahadkar@voltas.com),  
North: [psnorth@voltas.com](mailto:psnorth@voltas.com), East: [pseast@voltas.com](mailto:pseast@voltas.com), South: [psouth@voltas.com](mailto:psouth@voltas.com), West: [pswest@voltas.com](mailto:pswest@voltas.com)  
Website: [www.voltas.com](http://www.voltas.com)

**NORTH ZONE:** DELHI (011) 66505659/66505678/66505680/66505657 **CHANDIGARH** (0172) 4111800 **JAIPUR** (0141) 6541011 **LUCKNOW** 8840739788  
**EAST ZONE:** KOLKATA (033) 66266268 / 662662283 / 66266262 **BHUBANESHWAR** (0674) 2747868 **PATNA** (0612) 2500786 **RAIPUR** (077) 14033886  
**WEST ZONE:** MUMBAI (022) 66656754/ 66656756 / 66656757 / 66656759 / 66656760 **NAGPUR** (0712) 6456894 **AHMEDABAD** (079) 66301102 / 66301107 **PUNE** (020) 66297446 **INDORE** (0731) 2498616 **SOUTH ZONE:** CHENNAI (044) 66762357 / 66760346 / 66760355 **BENGALURU** (080) 22535648  
**HYDERABAD** (040) 66743007 **COCHIN** (0484) 6605527.

India's Largest Air Conditioning Company

**VOLTAS**  
A **TATA** Product

Voltas VXV **GEN6** VRF series

**VXV 6 Series**  
**ALL DC Inverter**

with **VEER** Technology



Outdoor Units - Upto 88 HP

VLVRF/INV/07/2020



# Profile

*Voltas, a member of the Tata Group, is India's No.1 air conditioning company and one of the world's premier engineering solutions providers and project specialists.*

*Founded in India in 1954, Voltas Limited offers premier cooling and engineering solutions for a wide spectrum of industries in areas such as heating, ventilation and air conditioning, refrigeration, electro-mechanical projects, textile machinery, mining and construction equipment, water management & treatment, cold chain solutions, building management systems, electrification and indoor air quality.*

*The Company's strengths lies principally in:*

- Management and execution of electro-mechanical projects, Including air conditioning and refrigeration.
- Sourcing, installation and servicing of diverse technology-based systems serving Indian industries through representation of global technology leaders.

## Organization

*Voltas' operations have been organized into three independent business-specific clusters. Each of these has its own facilities for market coverage and service to customers.*

## Unitary Cooling Products

- ★ Air Conditioners
- ★ Commercial Refrigeration
- ★ Water Coolers & Dispensers

## Domestic Projects Group

- ★ Electrical, Mechanical & Refrigeration Solutions
- ★ Electrical & Mechanical Solutions (international)
- ★ Electrical Projects Business - focusing on Rural
- ★ Electrification (Distribution / Improvement)
- ★ Water Management Business Division - Large Capacity STP (MLD), Effluent treatment, Rural Water Supply Scheme.
- ★ Customer Care - Life Cycle Management through managed services

## Engineering Products and Services

- ★ Textile Machinery
- ★ Mining & Construction Equipment

# Awards & Recognition

### 2018

- ★ Voltas "**India's Most Trusted Air Conditioner Brand**"
- ★ Strategy Leaders Summit & Awards 2018.
- ★ MEP Contractor and Plumbing Project of the Year award.

### 2017

- ★ **Indywood Built in India Excellence award**
- ★ **IGBC** - 'Gold' rating for Voltas Limited Office at Coimbatore.

### 2016

- ★ **Winner of Eco Times'** Best Corporate Brands 2016

### 2015

- ★ **Dun & Bradstreet Corporate Awards**
- ★ **Top Taxpayers' Award** Dept. of Central Excise & Service Tax
- ★ **EFFIE Award (silver)** for Effectiveness in Advertising

### 2014

- ★ **Tata Group's Excellence in Communications Award**
- ★ **World Advertising Research Centre** Asia Awards Gold Prize
- ★ **National Energy Conservation Award**  
Govt. of India Ministry of Power



Voltas was recognised as the '**Best Brand in Digital Marketing Excellence** in Consumer Durables Category' at **DigiXX 2018**



Voltas Domestic Projects Group recognized at **Indywood Built In India Excellence Awards 2018**

### 2008 / 2010 / 2011 / 2012 / 2013

- ★ **MEP Middle East Awards**
- ★ **MEP Contractor of the Year**
- ★ **MEP Project Manager of the Year' and 'Health & Safety'.**
- ★ **Silver LEED certification**
- ★ **Bry-Air Award for excellence in product Design for VAM**

# Product Lineup

## Modular VRF Outdoor Unit ( All DC Inverter )

Capacity	(kW)	25.2	28.0	33.5	40.0	45.0	50.4	56.0	61.5
	(HP)	8	10	12	14	16	18	20	22

### VXV 6



Top Discharge Modular

•	•	•	•	•	•	•	•	•
---	---	---	---	---	---	---	---	---

## Individual VRF Outdoor Unit

Capacity	(kW)	61.5	67.0	73.0	78.5	85.0	90.0
	(HP)	22	24	26	28	30	32

### VXV

Individual Series

Top Discharge Non-Modular

•	•	•	•	•	•	•
---	---	---	---	---	---	---

## Mini VRF Outdoor Unit

Capacity(kW)	Appearance	8	10	12	14	16	22	28
--------------	------------	---	----	----	----	----	----	----

### VXV Mini

Side Discharge



•	•	•	•	•	•	•	•
---	---	---	---	---	---	---	---

## Indoor Unit

Capacity(kW)	Appearance	2.2	2.8	3.6	4.5	5.6	7.1	8.0	9.0	10.0	11.2	12.5	14.0	15.0
One-way Cassette		•	•	•	•	•	•							
Two-way Cassette		•	•	•	•	•	•							
Four-way Cassette			•	•	•	•	•	•	•	•	•	•	•	
Slim Duct		•	•	•	•	•	•							
Mid ESP Duct					•	•	•	•	•	•	•	•	•	•
High ESP Duct											•	•	•	•
Ceiling&Floor					•	•	•	•	•	•	•	•	•	
Wall-mounted		•	•	•	•	•	•							

Capacity(kW)	Appearance	19.3	22.0	28.0	30.0	39.0	45.0	56.0
--------------	------------	------	------	------	------	------	------	------

### High ESP Duct



•	•	•	•	•	•	•
---	---	---	---	---	---	---

# VXV 6 Series

## Voltas presents latest 6th Generation VRF with All DC Inverter, VEER Technology and various features like...

### VEER Technology

Evaporating and condensing temperature makes strong effect to the cooling and heating performance and energy-efficiency ratio of AC system. Thanks to Variable Energy-Efficiency Regulation Technology, VXV6 series has various modes with different refrigerant temperature which lead the system to different performance and energy-efficiency ratio.

### High EER and COP

VXV 6 series achieves industry highest efficiency in cooling and heating by utilizing all DC inverter compressors. The cooling EER is upto 4.75 and heating COP is 5.48 for 8 HP model

### Wide Operation Range

VXV 6 has wide operating range from -15°C to 52°C. It doesn't matter whether it's as hot as 52°C or as low as -15°C outside, the system shall supply comfortable environment for occupants.

### Fast Warm Up and Cool Down

The DC Inverter Compressor system reaches full load rapidly providing less temperature fluctuation and an improved living environment, bring great user experience.

### DC Brushless Fan Motor

DC brushless motor adjusts the fan speed according to the system pressure, and running load to enhance the efficiency by 45%. The super aero fan provides a larger air volume and higher static pressure.

### High efficiency heat - exchanger

Optimized 2 to 1 refrigerant circuit design, increase the heat exchanging efficiency and enhance the ratio of liquid which flow to the evaporator.

### Precise Temperature Control

VOLTAS composite temperature control technology, through the indoor/outdoor operation condition detection, adjusts outdoor power output, optimize the indoor air distribution, achieve the high precision adjustment of 0.5.

### Refrigerant PCB Cooling System

The PCB is well cooled by the refrigerant, ensuring the system operate steadily even in hot area.



DLF - Belaire, Gurgaon

Mindtree, Hyderabad

Ackruti VIVA, Mumbai



# Features

## Variable Energy-Efficiency Regulation -VEER Technology

Evaporating and condensing temperature makes strong effect to the cooling and heating performance and energy-efficiency ratio of AC system.

Thanks to **VEER** technology, **VXV 6 Series** has various modes with different refrigerant temperature which lead the system to different performance and energy-efficiency ratio.

**Cooling:** 3 modes with different evaporating temperature.

**Heating:** 3 modes with different condensing temperature.

### Turbo mode

High cooling and heating performance, cool down or warm up the room rapidly.

### Basic mode

Default mode, balance the reaction speed and efficiency.

### High efficiency mode

Satisfy the lowest capacity requirement and low the energy consumption.

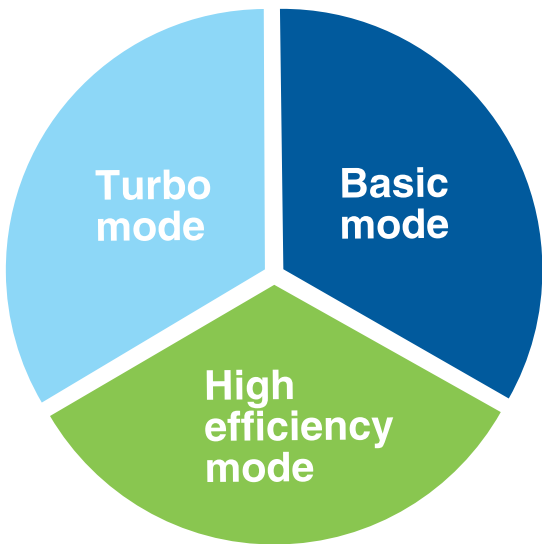

Users can choose a certain mode according to the actual need in different area and climate, so that the system can satisfy various requirement, and the seasonal efficiency can be optimized.

## Long Piping Length

Thanks to the DC inverter control technology and sub-cooling circuit technology, it is possible to design a system with longer piping and elevation difference which make it easier to design and installation.

Max. Total piping length — 1000m

Max. Actual piping length — 240m

Max. piping length from 1st indoor branch to the farthest indoor unit — 40m/90m\*

Max. Level difference between outdoor units — 5m

Max. Level difference between indoor units — 30m

Max. Level difference between ODU and IDU units — 110m

\*The longest length after first branch is 40m as standard can be extended to up to 90m under certain conditions. Please contact your local dealer for further information.

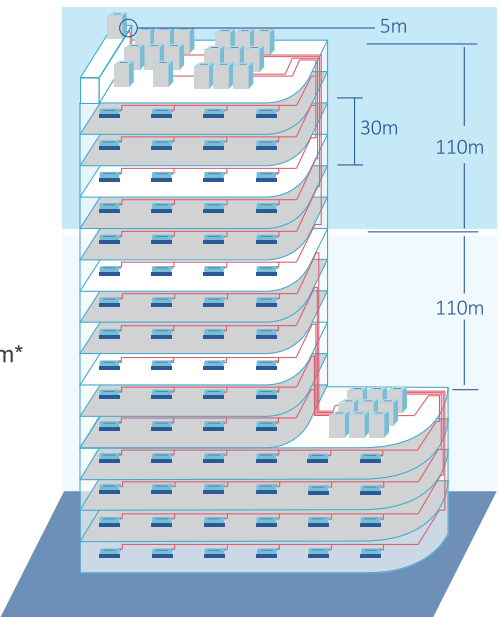



Features

DC Inverter Compresssor

Optimize the asymmetric vortex design

Heating condition, reducing the outlet temperature, increasing the compressor capacity, improving the heating performance.

Dynamic oil balance structure

Oil balance tube implementation parallel compressor and oil quantity dynamic equilibrium, ensuring the reliability of several paralleledcompressors.

High efficiency motor configuration

Using high quality material concentrated stator, cooperate with neodymium magnet rotor, having outstanding efficiency.

High pressure cavity structure

Large exhaust buffer volume, reducing the air flow noise and vibration of the runtime.

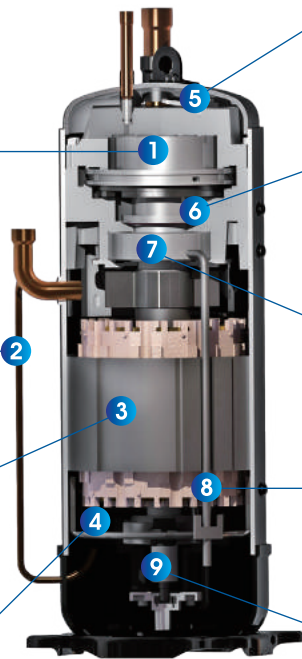

Pressure relief valve structure

Improving the partial load efficiency, adapt to the transformer ratio working condition, improving the compressor performance.

The intermediate pressure servo mechanism

According to the operation pressure among dynamic adjusting middle pressure, has realized the axial flexible, optimization of dynamic vortex disk meshing, improve product performance.

High reliability of the bearing

Adopt cylinder bearing and self-aligning ball bearing bearing group, improving the reliability of the compressor.

Internal oil circulation structure

Lubricating oil to achieve internal circulation, reducing heat loss, decreasing the rate of spitting oil, improve the efficiency and reliability.

Positive displacement gear oil pump

Positive displacement gear oil pump to ensure the high and low frequency can satisfy the oil supply, improving the reliability of the compressor.

All-round Protection

- High/low pressure protection
- Low pressure protection
- High/low compression ratio protection
- Low compression ratio protection
- High/low discharge temp. protection
- Low discharge temp. protection



Ground protection

- Voltage protection
- Current protection
- Fan motor protection
- Inverter module protection
- Compressor overload protection
- Phase sequence protection

Wide Operation Range

No matter in hot summer or cold winter, VXV 6 can supply comfortable environment for users.



Auto Dust Removal & Auto Snow-Blowing

The outdoor fan can rotate in reverse direction to remove dust on heat exchanger to ensure the heat exchange performance.



VXV 6 Series



VXV 6 Series 380–415V-50Hz

HP	8		10		12		14	
Model	VXV-H250/SR1MV		VXV-H280/SR1MV		VXV-H330/SR1MV		VXV-H400/SR1MV	
Combination	HP	8	10		12		14	
Capacity	Cooling	kW	25.2		28		33.5	
	Heating	kW	25.2		28		33.5	
Electric Data	Power supply	V~,Hz,Ph	380~415,50/60,3		380~415,50/60,3		380~415,50/60,3	
	Air Flow Volume	m³/h	12000		12000		12000	
Performance	Sound Pressure level	dB(A)	≤58		≤58		≤58	
	Type		DC inverter Scroll		DC inverter Scroll		DC inverter Scroll	
Compressor	Quantity		1		1		1	
	Type		DC motor		DC motor		DC motor	
Fan motor	Quantity		1		1		2	
	Type		DC motor		DC motor		DC motor	
Max. No. of Indoor Units	unit	13	16		20		23	
Connection Ratio	%	50~200	50~200		50~200		50~200	
Dimension (WxDxH)	Net	mm	990×765×1635		990×765×1635		1340×765×1635	
	Packing	mm	1030×825×1865		1030×825×1865		1395×825×1865	
Weight	Net	kg	215		215		265	
	Gross	kg	225		225		280	
Pipe Diameter	Liquid Side	mm	12.7		12.7		15.88	
	Gas Side	mm	22.2		22.2		28.6	
Operation Range	Cooling	°C	-5~52		-5~52		-5~52	
	Heating	°C	-15~24		-15~24		-15~24	
Stuffing Quantity	20/40/40H	unit	14/28/28		14/28/28		11/22/22	

HP	16		18		20		22	
Model	VXV-H450/SR1MV		VXV-H500/SR1MV		VXV-H560/SR1MV		VXV-H610/SR1MV	
Combination	HP	16	18		20		22	
Capacity	Cooling	kW	45		50.4		56	
	Heating	kW	45		50.4		56	
Electric Data	Power supply	V~,Hz,Ph	380~415,50/60,3		380~415,50/60,3		380~415,50/60,3	
	Air Flow Volume	m³/h	14000		16000		16000	
Performance	Sound Pressure level	dB(A)	≤61		≤63		≤63	
	Type		DC inverter Scroll		DC inverter Scroll		DC inverter Scroll	
Compressor	Quantity		1		2		2	
	Type		DC motor		DC motor		DC motor	
Fan motor	Quantity		2		2		2	
	Type		DC motor		DC motor		DC motor	
Max. No. of Indoor Units	unit	26	30		33		36	
Connection Ratio	%	50~200	50~200		50~200		50~200	
Dimension (WxDxH)	Net	mm	1340×765×1635		1340×765×1635		1340×765×1635	
	Packing	mm	1395×825×1865		1395×825×1865		1395×825×1865	
Weight	Net	kg	265		330		330	
	Gross	kg	280		345		345	
Pipe Diameter	Liquid Side	mm	15.88		15.88		15.88	
	Gas Side	mm	28.6		28.6		28.6	
Operation Range	Cooling	°C	-5~52		-5~52		-5~52	
	Heating	°C	-15~24		-15~24		-15~24	
Stuffing Quantity	20/40/40H	unit	11/22/22		11/22/22		11/22/22	

Notes:

1.Cooling Capacity: Indoor temperature 27°C DB/19°C WB; Outdoor temperature:35°C DB/ 24°C WB.

2.Heating Capacity: Indoor temperature 20°C DB; Outdoor temperature: 7°C DB/ 6°C WB.

3.Piping Length: Equivalent piping length: 7.5m, level difference: 0m.

4.We can guarantee the operation only within 130% Combination. If you want to connect more than 130% combination, please contact us and discuss the requirement.

5.Anechoic chamber conversion value, measured in test room. During actual operation. These values are normally somewhat higher as a result of ambient conditions.

6.The above designs and specifications are subject to change without prior notice. Final specifications please refer to technical specification provided by sales representative.

7.Sound values are measured in a semi-anechoic room, at a position 1m in front of the unit and 1.3m above the floor.

8.The above combined types are factory-recommended type. Customized modular combination can be done at will.

# VXV 6 Individual Series

22/24HP



26/28/30/32HP



HP			22	24	26	28	30	32
Model	Outdoor	50Hz	VXV-H620/5R1I	VXV-H670/5R1I	VXV-H730/5R1I	VXV-H780/5R1I	VXV-H850/5R1I	VXV-H900/5R1I
Capacity	Cooling	kW	61.5	67	73	78.5	85	90
	Heating	kW	69	75	81.5	87.5	95	100
Electric Data	Power supply	V~,Hz,Ph	380 ~415, 50, 3	380 ~415, 50, 3	380 ~415, 50, 3	380 ~415, 50, 3	380 ~415, 50, 3	380 ~415, 50, 3
	Air Flow Volume	m³/h	21000	21000	28000	28000	30000	30000
Performance	Sound Pressure level	dB(A)	≤63	≤63	≤65	≤65	≤65	≤65
	Type		DC inverter Scroll	DC inverter Scroll	DC inverter Scroll	DC inverter Scroll	DC inverter Scroll	DC inverter Scroll
Compressor	Quantity		2	2	2	2	2	2
Fan Motor	Quantity		2	2	2	2	2	2
Max. No. of Indoor Units		unit	36	39	43	46	50	53
Connection Ratio			50~130%	50~130%	50~130%	50~130%	50~130%	50~130%
Dimension (WxDxH)	Net	mm	1590×765×1600	1590×765×1600	2350×765×1600	2350×765×1600	2350×765×1600	2350×765×1600
	Packing	mm	1650×815×1770	1650×815×1770	2410×815×1770	2410×815×1770	2410×815×1770	2410×815×1770
Weight	Net	kg	400	400	500	500	500	500
	Gross	kg	420	420	515	515	515	515
Refrigerant Type			R410A	R410A	R410A	R410A	R410A	R410A
Pipe Diameter	Liquid Side	mm	15.88	15.88	19.05	19.05	19.05	19.05
	Gas Side	mm	28.6	28.6	34.9	34.9	34.9	34.9
Operation Range	Cooling	°C	-5~52	-5~52	-5~52	-5~52	-5~52	-5~52
	Heating	°C	-20~27	-20~27	-20~27	-20~27	-20~27	-20~27
Stuffing Quantity		unit	7/14/14	7/14/14	4/8/8	4/8/8	4/8/8	4/8/8

Notes:  
1.Cooling Capacity: Indoor temperature 27°C DB/19°C WB; Outdoor temperature: 35°C DB/ 24°C WB.  
2.Heating Capacity:Indoor temperature 20°C DB; Outdoor temperature:7°C DB/ 6°C WB.  
3.Piping Length:Equivalent piping length: 7.5m, level difference: 0m.  
4.Anechoic chamber conversion value, measured in test room. During actual operation.These values are normally somewhat higher as a result of ambient conditions.  
5.The above designs and specifications are subject to change without prior notice. Final specifications please refer to technical specification provided by sales representative.  
6.Sound values are measured in a semi-anechoic room, at a position 1m in front of the unit and 1.3m above the floor,  
7.The above combined types are factory-recommended type.

# VXV Mini Series

The outdoor units capacity range from 8kW to 28kW both in Single phase & 3 Phasewhich is ideal for small offices, villas, apartment and shops, making it perfect for commercial and residential application.

4.4 HP, 5 HP, 5.7 HP, 8 HP & 10 HP



2.9 HP & 3.6 HP



## All DC Inverter

Model	Outdoor		VXV-H080/NR1	VXV-H100/NR1	VXV-H120/NR1	VXV-H140/NR1	VXV-H160/NR1
Capacity	Cooling	kW	8.00	10.00	12.30	14.00	16.00
	Heating	kW	9.00	11.50	13.20	16.00	18.00
Electric Data	Power Supply	V~,Hz,Ph	220~240,50/60,1	220~240,50/60,1	220~240,50/60,1	220~240,50/60,1	220~240,50/60,1
Performance	Air Flow Volume	m³/h	4154	4154	7200	7200	7200
	Noise Level	dB(A)	56	57	57	57	57
Piping Limite	Level difference between IDU and ODU	m	30	30	30	30	50
	Level difference between IDU and IDU	m	10	10	15	15	15
	Between the first brance and the Farthest IDU	m	40	40	40	40	40
	Total Pipe length	m	100	100	250	300	300
Max. No. of Indoor Units		unit	4	5	6	6	7
Connection Ratio		%	50~130	50~130	50~130	50~130	50~130
Dimension (WxDxH)	Net	mm	970×395×803	970×395×803	940×340×1320	940×340×1320	940×340×1320
	Packing	mm	1090×480×855	1090×480×855	1080×430×1440	1080×430×1440	1080×430×1440
Weight	Net	kg	66	66	86	86	93
	Gross	kg	71	71	91	91	98
Refrigerant Type			R410A	R410A	R410A	R410A	R410A
Pipe Diameter	Liquid Side	mm(inch)	9.52(3/8)	9.52(3/8)	9.52(3/8)	9.52(3/8)	9.52(3/8)
	Gas Side	mm(inch)	15.88(5/8)	15.88(5/8)	15.88(5/8)	15.88(5/8)	19.05(3/4)
Operation Range	Cooling	°C	-15~49	-15~49	-15~49	-15~49	-15~49
	Heating	°C	-15~27	-15~27	-15~27	-15~27	-15~27
Stuffing Quantity		unit	48/96/150	48/96/150	48/96/150	26/54/54	26/54/54

Model	Outdoor		VXV-H220/5NR1A	VXV-H280/5NR1A
Capacity	Cooling	kW	22.40	28.00
	Heating	kW	24.50	28.50
Electric Data	Power Supply	V~,Hz,Ph	380~415,50,3	380~415,50,3
Performance	Air Flow Volume	m³/h	15300	15300
	Noise Level	dB(A)	60	60
Piping Limit	Vertical Pipe Length	m	≤30	≤30
	Actual Pipe Length	m	45	45
	Equivalent Pipe Length	m	50	50
	Total Pipe length	m	100	100
Max. No. of Indoor Units		unit	11	12
Connection Ratio		%	50~130	50~130
Dimension (WxDxH)	Net	mm	1120×400×1510	1120×400×1510
	Packing	mm	1270×560×1710	1270×560×1710
Weight	Net	kg	150	150
	Gross	kg	170	170
Refrigerant Type			R410A	R410A
Pipe Diameter	Liquid Side	mm(inch)	9.52(3/8)	9.52(3/8)
	Gas Side	mm(inch)	22.22(7/8)	22.22(7/8)
Operation Range	Cooling	°C	-10~52	-10~52
	Heating	°C	-15~24	-15~24
Stuffing Quantity		unit	17/37/37	17/37/37

Notes:  
1.Cooling Capacity: Indoor temperature 27°C DB/ 19°C WB; Outdoor temperature:35°C DB/ 24°C WB.  
2.Heating Capacity: Indoor temperature 20°C DB; Outdoor temperature: 7°C DB/ 6°C WB.  
3.Piping Length: Equivalent piping length: 7.5m, level difference: 0m.  
4.Anechoic chamber conversion value, measured in test room. During actual operation. These values are normally somewhat higher as a result of ambient c onditions.  
5.The above designs and specifications are subject to change without prior notice. Final specifications please refer to technical specification provided by sales representative.



# VXV Series - Indoor Range



## One Way Cassette

Model	Indoor		VXVC1-H028/4R1A	VXVC1-H036/4R1A	VXVC1-H045/4R1A	VXVC1-H056/4R1A	VXVC1-H071/4R1A
Capacity	Cooling	kW	2.8	3.6	4.5	5.6	7.1
	Heating	kW	3.2	4	5	6.3	8
Electric Data	Power Supply	V~, Hz, Ph	220~240, 50, 1	220~240, 50, 1	220~240, 50, 1	220~240, 50, 1	220~240, 50, 1
	Rated Power	W	40	40	45	45	50
Performance	Air Flow Volume(Hi/Mid/Low)	m <sup>3</sup> /h	510/410/310	600/480/360	720/570/450	910/830/700	1000/850/750
	Noise Level(Hi/Mid/Low)	dB (A)	36/34/30	38/28/26	42/39/35	45/41/39	47/43/40
Dimension (WxDxH)	Net(Body)	mm	870×460×250	870×460×250	870×460×250	1180×495×290	1180×495×290
	Packing(Body)	mm	1130×570×355	1130×570×355	1130×570×355	1440×660×385	1440×660×385
	Net(Panel)	mm	1070×520×33	1070×520×33	1070×520×33	1380×550×33	1380×550×33
	Packing(Panel)	mm	1085×555×175	1085×555×175	1085×555×175	1400×585×175	1400×585×175
Weight	Net/Gross(Body)	kg	25/32	27/34	27/34	39/46	39/46
	Net/Gross(Panel)	kg	3/5	3/5	3/5	5/7	5/7



## Two Way Cassette

Model	Indoor		VXVC2-H028/4R1A	VXVC2-H036/4R1A	VXVC2-H045/4R1A	VXVC2-H056/4R1A	VXVC2-H071/4R1A
Capacity	Cooling	kW	2.8	3.6	4.5	5.6	7.1
	Heating	kW	3.2	4.0	5.0	6.3	8.0
Electric Data	Power Supply	V~, Hz, Ph	220~240, 50, 1	220~240, 50, 1	220~240, 50, 1	220~240, 50, 1	220~240, 50, 1
	Rated Power	W	60	62	68	85	94
Performance	Air Flow Volume(Hi/Mid/Low)	m <sup>3</sup> /h	550	620	780	900	1165
	Noise Level(Hi/Mid/Low)	dB (A)	36/32/29	36/32/29	39/35/30	39/35/30	43/39/36
Dimension (WxDxH)	Net(Body)	mm	840×520×315	840×520×315	960×520×315	960×520×315	1200×520×315
	Packing(Body)	mm	1145×685×395	1145×685×395	1265×685×395	1265×685×395	1505×685×395
	Net(Panel)	mm	1083×630×33	1083×630×33	1203×630×33	1203×630×33	1443×630×33
	Packing(Panel)	mm	1100×665×175	1100×665×175	1220×665×175	1220×665×175	1460×665×175
Weight	Net/Gross(Body)	kg	31/38	31/38	36/43	36/43	39/46
	Net/Gross(Panel)	kg	4.5/6.5	4.5/6.5	5/7	5/7	7.5/11.5



## Compact Four Way Cassette

Model	Indoor		VXVCA-H028/R1X	VXVCA-H036/R1X	VXVCA-H045/R1X	VXVCA-H056/R1X
Capacity	Cooling	kW	2.8	3.6	4.5	5.6
	Heating	kW	3.0	4.3	5.0	6.0
Electric Data	Power Supply	V~, Hz, Ph	220~240, 50/60, 1	220~240, 50/60, 1	220~240, 50/60, 1	220~240, 50/60, 1
	Rated Power	W	33.5	33.5	33.5	33.5
Performance	Air Flow Volume(Hi/Mid/Low)	m <sup>3</sup> /h	700/600/530	700/600/530	700/600/530	700/600/530
	Noise Level(Hi/Mid/Low)	dB (A)	45/41/35	45/41/35	45/41/35	45/41/35
Dimension (WxDxH)	Net(Body)	mm	570×630×260	570×630×260	570×630×260	570×630×260
	Packing(Body)	mm	650×710×290	650×710×290	650×710×290	650×710×290
	Net(Panel)	mm	650×650×55	650×650×55	650×650×55	650×650×55
	Packing(Panel)	mm	710×710×80	710×710×80	710×710×80	710×710×80
Weight	Net/Gross(Body)	kg	19/21	19/21	19/21	19/21
	Net/Gross(Panel)	kg	3/5	3/5	3/5	3/5

Notes:  
1.Cooling Capacity: Indoor temperature 27°C DB/19°C WB;Outdoor temperature:35°C DB/24°C WB.  
2.Heating Capacity:Indoor temperature 20°C DB;Outdoor temperature:7°C DB/6°C WB.  
3.Piping Length:Equivalent piping length: 7.5m,l evel difference: 0m.  
4.Sound level is measured at 1.4m below the unit.  
5.The above designs and specifications are subject to change without prior notice. Final specifications please refer to technical specification provided by sales representative.

# VXV Series - Indoor Range



## Four Way Cassette

Model	Indoor		VXVCA-H071/4R1B	VXVCA-H080/4R1B	VXVCA-H090/4R1B	VXVCA-H100/4R1B
Capacity	Cooling	kW	7.1	8.0	9.0	10.0
	Heating	kW	8.0	10.0	11.0	12.0
Electric Data	Power Supply	V~, Hz, Ph	220~240, 50, 1	220~240, 50, 1	220~240, 50, 1	220~240, 50, 1
	Rated Power	W	100	100	176	176
Performance	Air Flow Volume(Hi/Mid/Low)	m <sup>3</sup> /h	1250/1040/910	1250/1040/910	1500/1200/1050	1500/1200/1050
	Noise Level(Hi/Mid/Low)	dB (A)	38/34/30	38/34/30	41/37/34	41/37/34
Dimension (WxDxH)	Net(Body)	mm	835×835×250	835×835×250	835×835×250	835×835×250
	Packing(Body)	mm	910×910×310	910×910×310	910×910×310	910×910×310
	Net(Panel)	mm	950×950×55	950×950×55	950×950×55	950×950×55
	Packing(Panel)	mm	1000×1000×100	1000×1000×100	1000×1000×100	1000×1000×100
Weight	Net/Gross(Body)	kg	27/34	27/34	28/35	28/35
	Net/Gross(Panel)	kg	5/7	5/7	5/7	5/7

Model	Indoor		VXVCA-H112/4R1B	VXVCA-H125/4R1B	VXVCA-H140/4R1B
Capacity	Cooling	kW	11.2	12.5	14.0
	Heating	kW	12.8	13.3	15.0
Electric Data	Power Supply	V~, Hz, Ph	220~240, 50, 1	220~240, 50, 1	220~240, 50, 1
	Rated Power	W	200	200	200
Performance	Air Flow Volume(Hi/Mid/Low)	m <sup>3</sup> /h	1800/1440/1260	1800/1440/1260	1800/1440/1260
	Noise Level(Hi/Mid/Low)	dB (A)	41/38/35	41/38/35	41/38/35
Dimension (WxDxH)	Net(Body)	mm	835×835×290	835×835×290	835×835×290
	Packing(Body)	mm	910×910×350	910×910×350	910×910×350
	Net(Panel)	mm	950×950×55	950×950×55	950×950×55
	Packing(Panel)	mm	1000×1000×100	1000×1000×100	1000×1000×100
Weight	Net/Gross(Body)	kg	30/37	30/37	30/37
	Net/Gross(Panel)	kg	5/7	5/7	5/7



## Low ESP Duct

Model	Indoor		VXVSD-H022/4R1A	VXVSD-H028/4R1A	VXVSD-H036/4R1A	VXVSD-H045/4R1A	VXVSD-H056/4R1A	VXVSD-H071/4R1A
Capacity	Cooling	kW	2.2	2.8	3.6	4.5	5.6	7.1
	Heating	kW	2.5	3.0	4.3	5.0	6.0	8.0
Electric Data	Power Supply	V~, Hz, Ph	220~240, 50, 1	220~240, 50, 1	220~240, 50, 1	220~240, 50, 1	220~240, 50, 1	220~240, 50, 1
	Rated Power	W	59	59	65	91	91	113
Performance	Air Flow Volume(Hi/Mid/Low)	m <sup>3</sup> /h	480/390/320	480/390/320	560/430/390	850/680/575	850/680/575	1000/810/685
	Noise Level(Hi/Mid/Low)	dB (A)	30/26/23	30/26/23	32/28/25	38/35/32	38/35/32	39/36/32
Dimension (WxDxH)	External Static Pressure(ESP)	Pa	10/30	10/30	10/30	10/30	10/30	10/30
	Net(Body)	mm	840×460×185	840×460×185	840×460×185	1160×460×185	1160×460×185	1160×460×185
	Packing(Body)	mm	1030×545×250	1030×545×250	1030×545×250	1350×545×250	1350×545×250	1350×545×250
	Net/Gross(Body)	kg	15.5/19	15.5/19	16.5/20	20/24	20/24	22/26

Notes:  
1.Cooling Capacity: Indoor temperature 27°C DB/19°C WB;Outdoor temperature:35°C DB/24°C WB.  
2.Heating Capacity:Indoor temperature 20°C DB;Outdoor temperature:7°C DB/6°C WB.  
3.Piping Length:Equivalent piping length: 7.5m,l evel difference: 0m.  
4.Sound level is measured at 1.4m below the unit.  
5.The above designs and specifications are subject to change without prior notice. Final specifications please refer to technical specification provided by sales representative.

# VXV Series - Indoor Range



## Medium ESP Duct

Model	Indoor		VXVMD-H045/4R1A	VXVMD-H056/4R1A	VXVMD-H071/4R1A	VXVMD-H080/4R1A	VXVMD-H090/4R1A
Capacity	Cooling	kW	4.5	5.6	7.1	8.0	9.0
	Heating	kW	5.0	6.0	8.0	10.0	11.0
Electric Data	Power Supply	V~,Hz,Ph	220~240,50,1	220~240,50,1	220~240,50,1	220~240,50,1	220~240,50,1
	Rated Power	W	100	100	160	160	160
Performance	Air Flow Volume(Hi/Mid/Low)	m <sup>3</sup> /h	950/850/700	950/850/700	1300/1100/850	1300/1100/850	1500/1200/1050
	Noise Level(Hi/Mid/Low)	dB (A)	40/37/33	40/37/33	41/39/36	41/39/36	44/41/39
	External Static Pressure(ESP)	Pa	50/80	50/80	50/80	50/80	50/80
Dimension	Net(Body)	mm	890×735×290	890×735×290	890×735×290	890×735×290	890×735×290
	Packing(Body)	mm	1070×800×360	1070×800×360	1070×800×360	1070×800×360	1070×800×360
Weight	Net/Gross(Body)	kg	29.5/34	29.5/34	30.5/35	30.5/35	32.5/37

Model	Indoor		VXVMD-H100/4R1A	VXVMD-H112/4R1A	VXVMD-H125/4R1A	VXVMD-H140/4R1A	VXVMD-H150/4R1A
Capacity	Cooling	kW	10.0	11.2	12.5	14.0	15.0
	Heating	kW	12.0	12.8	13.3	15.0	16.0
Electric Data	Power Supply	V~,Hz,Ph	220~240,50,1	220~240,50,1	220~240,50,1	220~240,50,1	220~240,50,1
	Rated Power	W	180	180	180	240	240
Performance	Air Flow Volume(Hi/Mid/Low)	m <sup>3</sup> /h	1400/1200/950	2000/1700/1400	2000/1700/1400	2200/1850/1550	2200/1850/1550
	Noise Level(Hi/Mid/Low)	dB (A)	44/41/39	45/42/39	45/42/39	47/43/41	47/43/41
	External Static Pressure(ESP)	Pa	50/80	50/80	50/80	50/80	50/80
Dimension	Net(Body)	mm	890×735×290	1250×735×290	1250×735×290	1250×735×290	1250×735×290
	Packing(Body)	mm	1070×800×360	1430×800×360	1430×800×360	1430×800×360	1430×800×360
Weight	Net/Gross(Body)	kg	32.5/37	42/47	42/47	42/47	42/47



## High ESP Duct

Model	Indoor		VXVHD-H112/4R1A	VXVHD-H125/4R1A	VXVHD-H140/4R1A	ACVXVHD-H150/4R1V	ACVXVHD-H190/4R1V
Capacity	Cooling	kW	11.2	12.5	14.0	15.0	19.3
	Heating	kW	12.8	13.3	15.0	16.0	21.5
Electric Data	Power Supply	V~,Hz,Ph	220~240,50,1	220~240,50,1	220~240,50,1	220~240,50,1	220~240,50,1
	Rated Power	W	600	600	600	600	900
Performance	Air Flow Volume (Hi/Mid/Low)	m3/h	2000/1600/1400	2000/1600/1400	2000/1600/1400	2890/2745/2600	3740/3553/3366
	Noise Leve l(Hi/Mid/Low)	dB (A)	48/46/44	48/46/44	48/46/44	50/48/47	51/49/48
	External Static Pressure (ESP)	Pa	196	196	196	196	196
Dimension	Net	mm	1200×719×380	1200×719×380	1200×719×380	1130×750×475	1228×665×404
	Packing	mm	1235×760×415	1235×760×415	1235×760×415	1230×800×525	1328×715×454
Weight	Net/Gross	kg	56/59	56/59	56/59	58/83	65/90
	Liquid Side	mm(inch)	9.52(3/8)	9.52(3/8)	9.52(3/8)	12.7 (1/2)	12.7 (1/2)

Model	Indoor		VXVHD-H220/4R1B	VXVHD-H280/4R1B	ACVXVHD-H300/4R1V	ACVXVHD-H390/4R1V	ACVXVHD-H560/5R1V
Capacity	Cooling	kW	22.4	28.0	30.0	39.0	56.0
	Heating	kW	25.0	31.5	33.0	43.0	61.5
Electric Data	Power Supply	V~,Hz,Ph	220~240,50,1	220~240,50,1	220~240,50,1	220~240,50,1	380~415,50,3
	Rated Power	W	1250	1250	1400	1700	2500
Performance	Air Flow Volume (Hi/Mid/Low)	m3/h	4000/3200/2600	4000/3200/2600	5780/5491/5202	7480/7106/6732	11220/10659/10098
	Noise Leve l(Hi/Mid/Low)	dB (A)	51/49/48	52/50/49	52/50/49	53/51/49	53/51/49
	External Static Pressure (ESP)	Pa	220	220	280	280	280
Dimension	Net	mm	1350×700×460	1350×700×460	1508×795×404	1820×780×475	2150×825×520
	Packing	mm	1540×810×610	1540×810×610	1608×845×454	1920×830×525	2250×875×570
Weight	Net/Gross	kg	91/110	91/110	90/115	110/135	180/205
	Liquid Side	mm(inch)	12.7(1/2)	12.7(1/2)	15.8 (5/8)	15.8 (5/8)	15.8 (5/8)

Notes:  
1.Cooling Capacity: Indoor temperature 27°C DB/19°C WB;Outdoor temperature:35°C DB/24°C WB.  
2.Heating Capacity:Indoor temperature 20°C DB;Outdoor temperature:7°C DB/6°C WB.  
3.Piping Length:Equivalent piping length: 7.5m,l evel difference: 0m.  
4.Sound level is measured at 1.4m below the unit.  
5.The above designs and specifications are subject to change without prior notice. Final specifications please refer to technical specification provided by sales representative.

# VXV Series - Indoor Range



## Wall Mounted

Model	Indoor		VXVWM-H022/4R1A(LH)	VXVWM-H028/4R1A(LH)	VXVWM-H036/4R1A(LH)	VXVWM-H045/4R1A(LH)	VXVWM-H056/4R1A(LH)	VXVWM-H071/4R1A(LH)
Capacity	Cooling	kW	2.2	2.8	3.6	4.5	5.6	7.1
	Heating	kW	2.5	3.0	4.3	5.0	6.0	8.0
Electric Data	Power Supply	V~,Hz,Ph	220~240,50,1	220~240,50,1	220~240,50,1	220~240,50,1	220~240,50,1	220~240,50,1
	Rated Power	W	38	38	38	68	68	82
Performance	Air Flow Volume (Hi/Mid/Low)	m3/h	650/600/580	650/600/580	650/600/580	850/750/650	850/750/650	1200/950/800
	Noise Leve l(Hi/Mid/Low)	dB (A)	38/33/27	38/33/27	38/33/27	45/41/35	45/41/35	48/45/39
Dimension	Net	mm	850×300×198	850×300×198	850×300×198	970×315×235	970×315×235	1100×330×235
	Packing	mm	905×357×267	905×357×267	905×357×267	1010*370*300	1010*370*300	1140*385*300
Weight	Net/Gross	kg	10/13	10/13	10/13	14/18	14/18	16/20

Notes:  
1.Cooling Capacity: Indoor temperature 27°C DB/19°C WB;Outdoor temperature:35°C DB/24°C WB.  
2.Heating Capacity:Indoor temperature 20°C DB;Outdoor temperature:7°C DB/6°C WB.  
3.Piping Length:Equivalent piping length: 7.5m,l evel difference: 0m.  
4.Sound level is measured 1m below the air outlet horizontally and vertically.  
5.The above designs and specifications are subject to change without prior notice. Final specifications please refer to technical specification provided by sales representative.



## Ceiling and Floor Mounted

Model	Indoor		VXVCF-H028/4R1A	VXVCF-H036/4R1A	VXVCF-H045/4R1A	VXVCF-H056/4R1A	VXVCF-H071/4R1A	VXVCF-H080/4R1A
Capacity	Cooling	kW	2.8	3.6	4.5	5.6	7.1	8.0
	Heating	kW	3.0	4.3	5.0	6.0	8.0	10.0
Electric Data	Power Supply	V~,Hz,Ph	220~240,50,1	220~240,50,1	220~240,50,1	220~240,50,1	220~240,50,1	220~240,50,1
	Rated Power	W	80	80	80	80	140	140
Performance	SEER/SCOP (Hi/Mid/Low)	m <sup>3</sup> /h	450/360/315	630/504/441	950/760/665	950/760/665	1300/1040/910	1500/1200/1050
	Noise Level (Hi/Mid/Low)	dB (A)	37/34/31	39/36/33	42/39/36	42/39/36	45/42/39	47/44/41
Dimension	Net(Body)	mm	929×660×205	929×660×205	929×660×205	929×660×205	1280×660×205	1280×660×205
	Packing(Body)	mm	1010×720×290	1010×720×290	1010×720×290	1010×720×290	1360×720×290	1360×720×290
Weight	Net/Gross(Body)	kg	26/29	26/29	26/29	26/29	35/39	35/39

Model	Indoor		VXVCF-H090/4R1A	VXVCF-H100/4R1A	VXVCF-H112/4R1A	VXVCF-H125/4R1A	VXVCF-H140/4R1A
Capacity	Cooling	kW	9.0	10.0	11.2	12.5	14.0
	Heating	kW	11.0	12.0	12.8	13.3	15.0
Electric Data	Power Supply	V~,Hz,Ph	220~240,50,1	220~240,50,1	220~240,50,1	220~240,50,1	220~240,50,1
	Rated Power	W	140	140	210	210	210
Performance	SEER/SCOP (Hi/Mid/Low)	m <sup>3</sup> /h	1500/1200/1050	1500/1200/1050	1800/1440/1260	1800/1440/1260	1800/1440/1260
	Noise Level (Hi/Mid/Low)	dB (A)	47/44/41	47/44/41	48/45/42	48/45/42	48/45/42
Dimension	Net(Body)	mm	1280×660×205	1280×660×205	1631×660×205	1631×660×205	1631×660×205
	Packing(Body)	mm	1360×720×290	1360×720×290	1710×720×290	1710×720×290	1710×720×290
Weight	Net/Gross(Body)	kg	35/39	35/39	45/51	45/51	45/51

Notes:  
1.Cooling Capacity: Indoor temperature 27°C DB/19°C WB; Outdoor temperature:35°C DB/24°C WB.  
2.Heating Capacity:Indoor temperature 20°C DB;Outdoor temperature:7°C DB/6°C WB.  
3.Piping Length:Equivalent piping length: 7.5m ,level difference: 0m.  
4.Floor standing:Sound level is measured 1m from air-outlet in horizontal distance, 1m above the floor in vertical distance.  
5.Ceiling mounted: Sound level is measured 1m from air-outlet in horizontal distance,1m from air-outlet in vertical distance.  
6.The above designs and specifications are subject to change without prior notice. Final specifications please refer to technical specification provided by sales representative.



# Fresh Air Processor

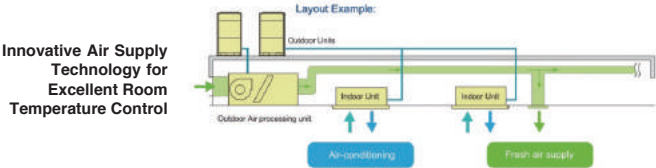

Long Distance Air Supply

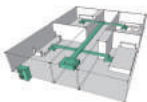

Applicable to a variety of Room Types

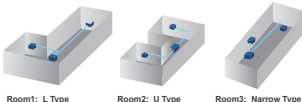

## Specification-50Hz AC fan motor

Model	Indoor		VXVFA-H220/4R1B	VXVFA-H280/4R1B	VXVFA-H450/5R1A	VXVFA-H560/5R1A
Capacity	Cooling	kW	22.4	28.0	45.0	56.0
	Heating	kW	18.0	22.0	49.5	61.5
Electric Data	Power Supply	V~,Hz,Ph	220~240,50,1	220~240,50,1	380~415,50,3	380~415,50,3
	Rated Power	W	1000	1000	1520	1520
Performance	Air Flow Volume(Hi/Mid/Low)	m³/h	3200	3200	4000	5000
	Noise Level(Hi/Mid/Low)	dB(A)	55	55	57	59
	External Static Pressure(ESP)	Pa	220	220	220	220
Dimension (WxDxH)	Net	mm	1350×700×460	1350×700×460	1820×990×855	2115×990×855
	Packing	mm	1540×810×610	1540×810×610	1935×1025×1015	2225×1025×1015
Weight	Net/Gross	kg	91/110	91/110	150/170	225/255
Pipe Diameter	Liquid Side	mm(inch)	12.7(1/2)	12.7(1/2)	12.7(1/2)x2	12.7(1/2)x2
	Gas Side	mm(inch)	22.2(7/8)	22.2(7/8)	22.2(7/8)x2	22.2(7/8)x2
	Drainage	mm	DN25	DN25	DN25	DN25
Stuffing Quantity	20/40/40H	unit	30/63/84	30/63/84	10/22/22	10/22/22

**Notes:**  
1. Cooling Capacity: Indoor temperature 27°C DB/ 19°C WB; Outdoor temperature:35°C DB/ 24°C WB. & Heating Capacity: Indoor temperature 20°C DB; Outdoor temperature:7°C DB/ 6°C WB.  
2. Piping Length: Equivalent piping length: 7.5m, level difference: 0m. & Sound level is measured at 1.4m below the unit.  
3. The above designs and specifications are subject to change without prior notice. Please refer to the final technical specifications provided by sales representative.  
**Connection Conditions:**  
1. The following restrictions must be observed in order to maintain the indoor units connected to the same system.  
2. When outdoor-air processing units are connected,the total connection capacity must be within 50% to 100% of that of the outdoor units.  
3. When outdoor-air processing units are standard indoor units are connected,the total connection capacity of the outdoor-processing units must not exceed 30% of that of the outdoor units.  
4. Outdoor-air processing units can be used without indoor units.

# VXV Series - Controls & Accessories

## Remote Controllers ( YK-L )

1 ON/OFF  
2 Fan Speed Setting  
3 Temperature-Setting /  
Timer Range Setting  
4 Cooling Mode  
5 Heating Mode  
6 Vertical Swing /  
Horizontal Swing

7 Mode Setting  
AUTO/COOL/DRY/  
HEAT/FAN  
8 Turbo Wind  
9 Health Function  
10 Silence Function  
11 Sleep Function  
12 Timer On/Off  
13 I Feel Function

14 LED Display On/Off  
15 Anti-fungus Function  
16 Clean Function  
17 Auxiliary Electric Heating  
18 Spot Swing  
19 Economic Function

**\*YK-L -for commissioning**

## Remote Controller ( YK-K )

1 Mode Setting  
AUTO/COOL/DRY/HEAT/FAN  
2 Fan Speed Setting  
HIGH/MED/LOW/AUTO  
3 Vertical Swing  
4 Feeling Function  
5 Strong Wind  
6 Sleep Function  
7 LED Display On/Off  
8 Temperature-Setting /  
Timer Range Setting  
9 ON/OFF  
10 Timer On/Off

11 Horizontal Swing  
12 Clean Function  
13 Health Function  
14 Fungusproof Function

## Wired Controller ( XK-05A )

1 Built in remote signal receiver  
2 Address stting  
3 Follow me  
4 Built-in timer  
5 User friendly and elegant design  
6 Error reporting  
7 Keyboard Locking

# VXV Series - Controls & Accessories

## Centralized Touch Screen Controllers



- Touch screen centralized control
- Multi system control
- Multiple lock function
- Weekly schedule control
- Indoor units operation status display
- Flexible wiring
- Keyboard Locking

## AHU Kit



Overall Structure

Partial fresh air system

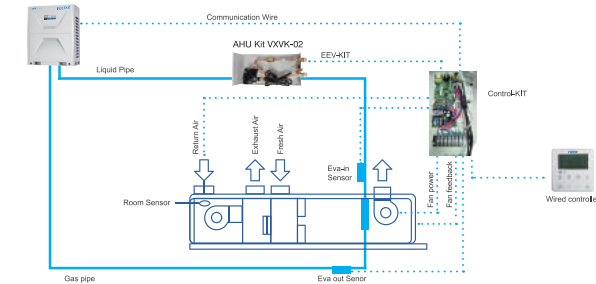

All fresh air system

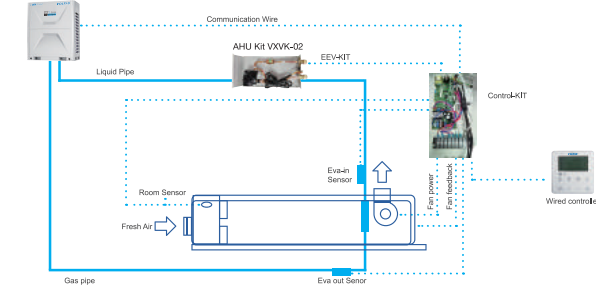

# VXV Series - Network Control

## Network Control Software

